

BATCHMASTER® IV COUNTER



Batchmaster® IV 5 Gate

Batchmaster® Counters are the only counters that utilize **patented** dual view scanners that provide the highest accuracy count possible. Out of tolerance parts are rejected prior to entering a package. The latest **Batchmaster®** IV counter is an accurate high speed counting system that detects and rejects parts one-third smaller or larger than a target part thereby separating the good parts from the bad.

Batchmaster® IV Benefits:

Flexibility - batch a wide variety shapes and sizes of product accurately with no changeover parts

Versatility - system integration to any type of packaging machine. Designed for short or long production runs

Count Accuracy – **patented** Dual View Scanner verifies the 3D volume of each part in real time. Out-of-tolerance product can be rejected before entering the package

Volumetric Accuracy – accumulated volumes routinely exceeds multi-head weigher accuracy and speeds

Quick Changeover— typical product changeover of 2 minutes or less. Recipe set ups can be saved on system or remote network. Bar code scanner can be added for quicker loading of saved recipes

Cost Savings – virtually no wear parts, servo motors with no linkages, decrease or eliminate product giveaway with this new patented precision filling technology

Value - increased output, 2 to 3 times faster than other counters on the market. Can count at over 100 batches per minute

VMAS Technology - Verified Movement & Speed of all mechanical movements via a true closed loop system, making this equipment easily validated

Batchmaster® IV Features:

- Auto Gate Fault Re-Start
- Auto Set-Up
- Bar Code Reading
- Closed Loop Stepper Motor Driven Gates
- Continuous Run, See Through Operation
- Counts Parts from 1/32" up to 7" X 7 X 10" long, Depending on Size of Parts Processing Unit
- Custom Password Lock Outs
- Enhanced Geometry Dual Axis Feeder
- Food Grade and Anti-Static Options
- High Resolution with 6,000 Scans per Second
- Improved Auto-Calibration and Dust Filtering
- Industrial Grade Stainless Steel Bowl, Hopper & Stand
- In-Flight Volume Analysis
- Large 10.4" Color Touch Screen HMI Controls
- Multi-Chamber Part Processor
- Multi-Language Options
- Multiple Dump Feature
- Out of Tolerance Batch Reject (On 5 Gate PPU)
- Partial Accumulation and Split Counts
- **Patented** Dual View Scanner with Part Validation
- Real Time Operational Data
- Recipe Management
- Self Diagnostics with Remote Capability
- Semi-Automatic or Integrates To Fill Any Type of Package
- Single Counts Run at up To 100's Of Batches per Minute
- State Of The Art High Speed Electronics
- Storable Set-Up Parameters of 500 Recipes
- Tool-Less Assembly / Disassembly & Changeover
- UL, cUL, & CE Approved Options
- User Friendly Intuitive Set-Up
- Variable Electronic Tuning To Run a Wide Range of Parts
- Verified Motion Control Technology

BSI

BATCHING SYSTEMS, INC.
ENGINEERED AUTOMATED PACKAGING SOLUTIONS

Applications: Aerospace, agricultural, automotive, beauty, candy, crafts, dental, electronics, fasteners, food, hardware, hobby, IQF products, jewelry, medical, plastics, pharmaceutical/nutraceutical, sporting goods, toy, and many others

Power Requirements:

120 VAC, 1 Phase, 60 Hz @ 15 Amps

Air Requirements:

No air or gate sensors are required.

All movements controlled and verified with stepper motors

Footprint:

50" deep x 30" to 36" wide. *Height varies depending on configuration and adjustment*

Part Size Range:

50mm PPU-Minimum thickness of 1/32 (.03") or .08mm up to 1.75" x 1.75" x 1.9" long

100mm PPU-Minimum thickness of 1/16" (.06") or 1.5mm up to 2.75"x2.75"x4" long

150mm PPU-Minimum thickness of 1/8" up to 5"x5"x8" long

200mm PPU-Minimum thickness of 1/4" up to 7"x7"x 10" long

Bowls / Feed Rate:

24EGV: up to 400 linear inches of feed per minute, can run parts as thin as 1/16"

15 or 18 OT: up to 250 linear inches of feed per minute, can run parts as thin as 1/32"

- BMIV is available in single, dual and belt feed configuration
- BMIV is available in 2 gate or 5 gate configuration
- Bulk feed hopper options are available that are engineered to meet your product and operation requirements
- Electronic upgrades available for existing counting systems. For more information see Upgrades Datasheet

Machine Footprint Single BMIV Side and Top View, Dual BMIV Top View

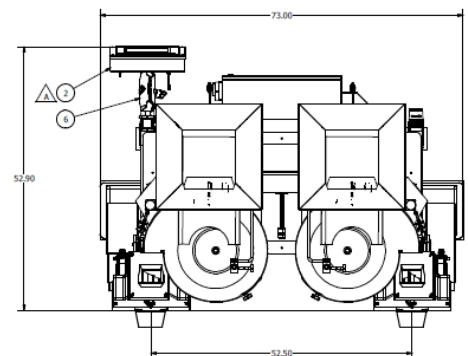
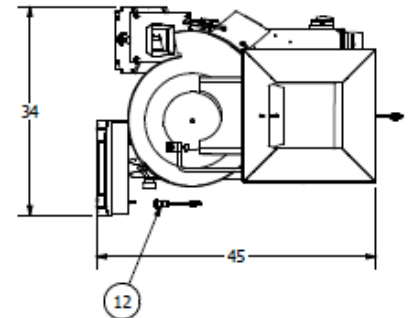
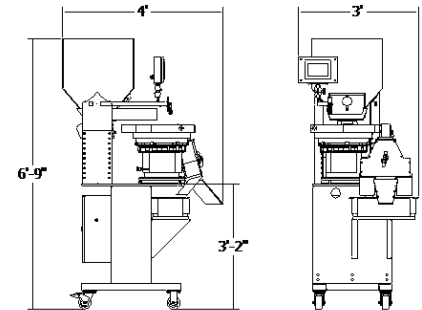

Dual Batchmaster® IV 5 Gate Bowl Feed



Batchmaster® IV 2 Gate Bowl Feed



Dual Batchmaster® IV DV200 5 Gate Belt Feed

Batching Systems, Inc. | sales@BatchingSystems.com | www.BatchingSystems.com | 410-414-8111

50 Jibsail Drive • Prince Frederick, MD 20678